

ELIMINATE FRUSTRATING CAPILLARY CONNECTION PROBLEMS

The Measure of Confidence

Agilent UltiMetal Plus Flexible Metal Ferrules



Make inert, leak-free connections between GC columns and Capillary Flow Technology (CFT) devices

Standard metal ferrules can fit poorly, resulting in overtightening that can cause columns to break during installation. **UltiMetal Plus Flexible Metal ferrules** remove these hassles – while delivering the inertness that today's analyses demand.

The novel, flexible design allows each ferrule to gently compress around the column, preventing column breakage or leakage. Stainless steel construction holds its shape during temperature cycling to maintain a leak-free connection without retightening. You can achieve better results, and process more samples, without unplanned maintenance and recalibration.

Other advantages include:

- **Confident, consistent seals:** Tighter ID tolerances accommodate a wide range of column tubing
- **Long term connections at high temperatures:** Fused silica column tubing does not break in the fitting after extended periods at high temperatures
- **Compatibility with Capillary Flow Technology devices** – including CFT backflush, effluent splitting, retention gap connections, GC by GC, Deans switch, and Low Thermal Mass GC column modules (LTM)
- **Less analyte loss:** UltiMetal Plus Flexible Metal ferrules are the *only* ferrules that won't introduce active sites into the flow path. Their chemical deactivation provides an inert surface for analyzing active analytes at trace levels.
- **The right ferrule for your application:** Choose from a wide range of inner diameters that accommodate all Agilent – and most other – capillary fused silica columns, including Agilent J&W UltiMetal GC columns. A no hole/plug option is also available.
- **Ease-of-use:** A wide opening lets you easily thread the column through the ferrule



In addition, each part number is uniquely designed to prevent inventory mix-ups, and help you find the ferrule you need quickly. Color variations between ferrules are a normal result of the UltiMetal coating.

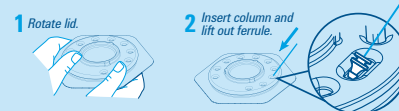

Touchless packaging prevents contamination.

Agilent UltiMetal Plus Flexible Metal ferrules are conveniently packaged to let you thread the column through the ferrule *while the ferrule is still in the package* – so you don't risk dropping or contamination while handling.

See the easy-to-use packaging at:
agilent.com/chem/flexipack



Column Connections Video

Watch a video demonstrating column connections including pre-swaging, trimming, and quality inspection:

agilent.com/chem/flexipreswag



Agilent Technologies

Confidently analyze active compounds – at trace levels

At trace levels, even the exposed surface of column ferrules can be a source of activity – causing loss of active, labile analytes. Agilent Flexible Metal ferrules with proprietary UltiMetal Plus treatment reduce active analyte loss, increase response, and improve your results.

Activity comparison: The average degradation (% breakdown) of Endrin and DDT are consistently lower with Agilent UltiMetal Plus Flexible Metal ferrules (green bars) than with standard metal ferrules (red bars).

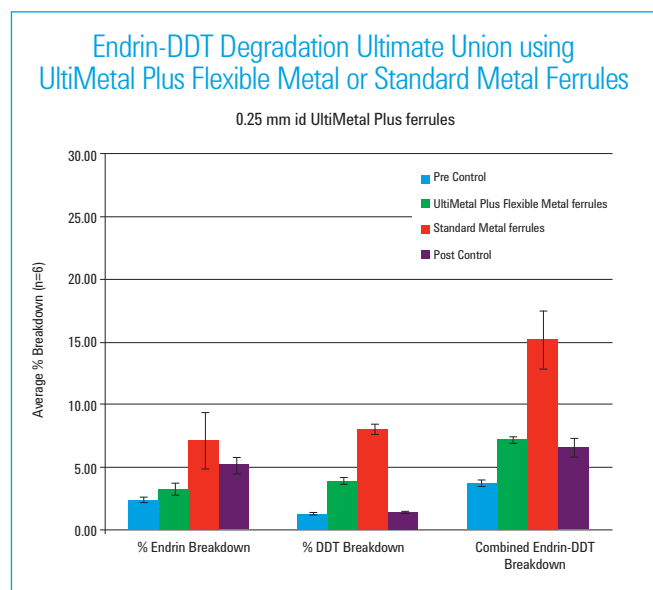

Agilent Inert Flow Path solutions ensure a reliably inert GC flow path for higher sensitivity, accuracy, and reproducibility... especially at trace levels.



Agilent UltiMetal Plus Flexible Metal ferrules are a key part of this path, because they allow you to make inert, leak-free column connections to CFT devices and inlet/detector fittings.

Other Inert Flow Path solutions include Agilent J&W Ultra Inert GC columns, Ultra Inert liners, GC and GC/MS instruments, Ultra Inert gold seals, and UltiMetal Plus metal parts.

To learn more, visit agilent.com/chem/inert

Agilent UltiMetal Plus Flexible Metal ferrules:
No column breakage, no leaks, no activity

Description	Part No.
UltiMetal Plus Flexible Metal ferrule with 0.4 mm id for fused silica tubing 0.1-0.25 mm id 10/pk	G3188-27501
UltiMetal Plus Flexible Metal ferrule with 0.5 mm id for fused silica tubing 0.32 mm id 10/pk	G3188-27502
UltiMetal Plus Flexible Metal ferrule with 0.8 mm id for fused silica tubing 0.45-0.53 mm id 10/pk	G3188-27503
UltiMetal Plus Flexible Metal ferrule with no hole to plug Capillary Flow Technology fittings	G3188-27504
UltiMetal Plus Flexible Metal ferrule for use with 0.25 mm and 0.32 mm id UltiMetal column tubing	G3188-27505
UltiMetal Plus Flexible Metal ferrule for use with 0.53 mm id UltiMetal column tubing	G3188-27506

To learn more about
Agilent Inert Flow Path solutions
visit agilent.com/chem/inert

Find your local Agilent Representative
or Agilent Authorized Distributor at
agilent.com/chem/contactus
or order at agilent.com/chem/flexiferrule

This information is subject to change without notice.

©Agilent Technologies, Inc., 2013
Printed in the USA, March 1, 2013
5991-2033EN

